

KITO

Easily Installable and Removable Electrical Supply Rail

KITO BUSBAR



Easy-to-use Simple-design KITO Busbar

Light-weight, Tough Busbar

The cell-shaped cross-section structure of the casing of the KITO Busbar helps secure high rigidity. Light-weight, touch design allows up to a 4-pole conductor to pass through.

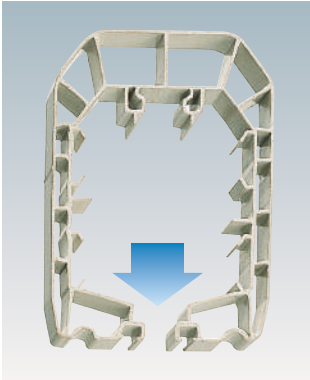

Innovation is also aesthetic.

KITO Busbar offers ergonomics without forgoing aesthetics. Elegant lines, harmonious colours, and coordinated elements result in a product which is both dynamic and smart, all combining to make this Busbar an aesthetically successful innovation.

Secure, Simple Rail Joint

Our original special-purpose connection bolt is used for the joint of the KITO Busbar, allowing easy installation of the rail by a firm tightening torque even if no torque wrench is used. With a 2-step-structure head, this special-purpose connection bolt separates the 1st-step bolt head upon reaching a specified torque, securely connecting the Busbar.

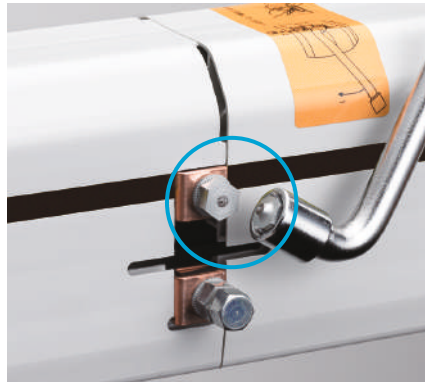

Degree of protection: choose high performance.

KITO Busbar makes the user's choice simpler by offering a complete range of accessories, all ensuring protection of the line against rain (IP23), thanks to an integrated watertight system.

Users : security and reliability.

As well as complying with standards and regulations in force, Busbar stands out for its hard-wearing qualities and ease of maintenance, thanks to the use of toolfree fitting of accessories.

Standard Specifications

Material used	Self-extinguishing vinyl chloride resin (PVC)
Rated voltage	750V
Rated current	4P-60A, 4P-100A
Ambient temperature	-20°C~+55°C
Ambient humidity	90%RH or less (No condensation)
Applicable standards	JIS C8373 (The verification test referred to JIS C8373 has been executed.) EN60439-2, EN60204-32
Protection grade	IP23

It is not possible to use for the special environment such as clean room and food relative.

Systematized Simple Joint Structure with Fewer Component Parts.
Allowing Quick and Easy Installation.



Accessories quickly fitted and removed.

For easier fitting and maintenance, the main accessories have been designed for simpler, quicker, tool-free installation. The feeding box and covering flange are clipped on manually. However, they cannot be removed without the use of a tool, in accordance with regulations.

How Easy to Mount to a Hanger!

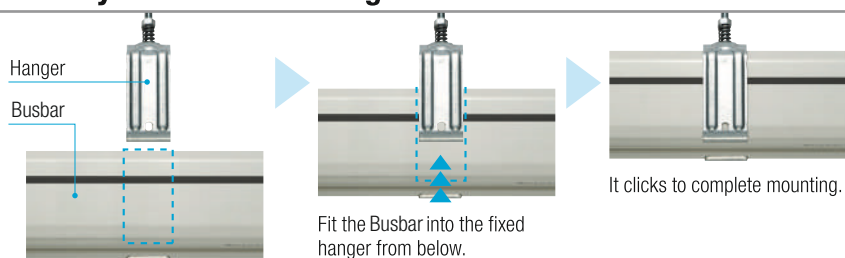

Installers : simplicity and flexibility.

Thanks to its limited number of parts, the systematic use of easily removed connections, and rapidly fitted accessories (without tools), Busbar offers installers a system which is simple and quick to set up, whatever the location.



Configuration of KITO Busbar

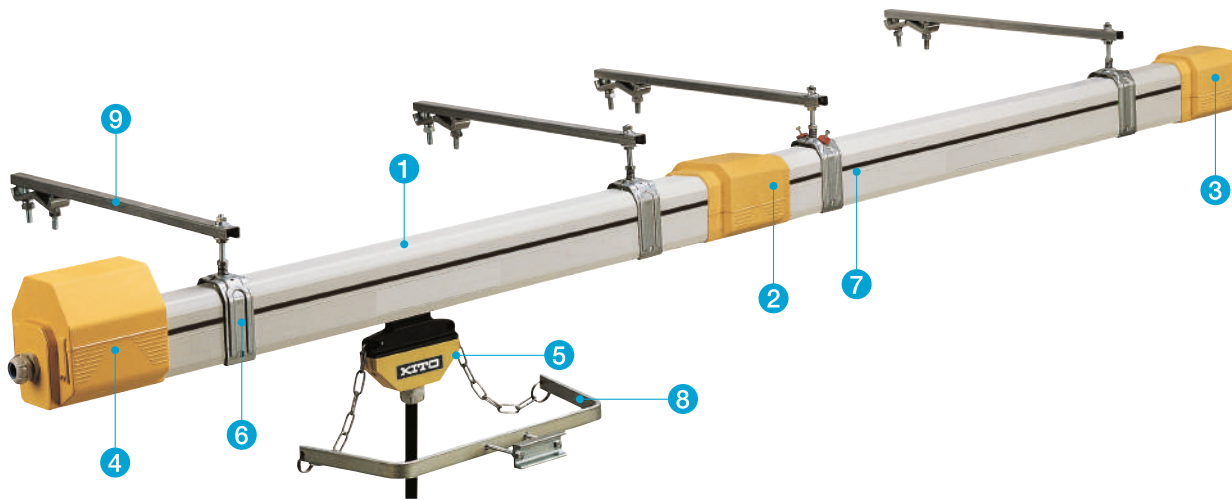

1 KITO Busbar

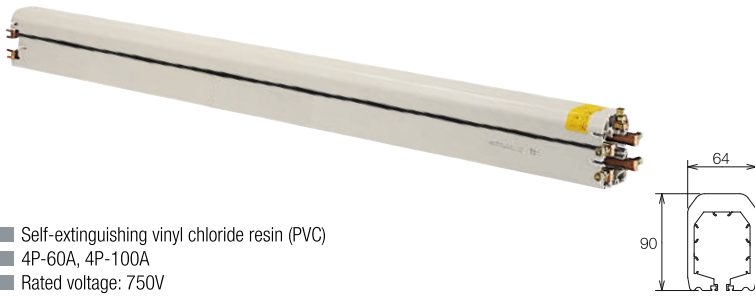

- Self-extinguishing vinyl chloride resin (PVC)
- 4P-60A, 4P-100A
- Rated voltage: 750V

Model	Standard length (m)	Poles-Rating	Mass (kg/m)
ME4604KTB	4	4P-60A	1.8
ME4603KTB	3		
ME4602KTB	2		
ME4601KTB	1		
ME4104KTB	4	4P-100A	2.0
ME4103KTB	3		
ME4102KTB	2		
ME4101KTB	1		

2 Covering Flange



- Self-extinguishing plastic
- Used to cover the joint of the Busbar. (Covering Flange)
- Mounted to the end of the Busbar. (End Cap)

3 End Cap



Model	Type	Mass (kg)
ME2000	common	0.2
ME2400		0.3

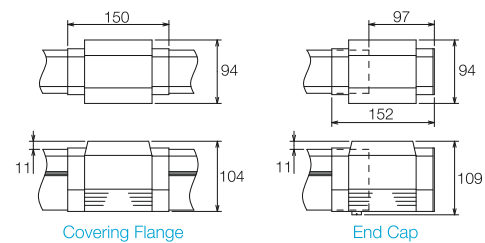

4 End-line Feed Box



- Self-extinguishing plastic
- Used for supplying the electricity to the Busbar from the end.

Model	Cable connector	Applicable cable O.D. (mm)	Poles	Mass (kg)	Dimensions (mm)	
					A	B
ME1230B	M32	15~25	4P	0.4	183	128
ME1250B	M40	21~32	4P		186	132

5-1 Trolley



- Travels within the Busbar, and provided with a current-collecting brush for receiving the electricity.
- The traveling speed should be 100 m/min. or less.

	Model	Cable connector	Type	Poles-Rating	Mass (kg)
5	ME3043KTB	M25	Single	4P-35A	0.6
	ME4042KTB	M25	Double	4P-35Ax2	1.1

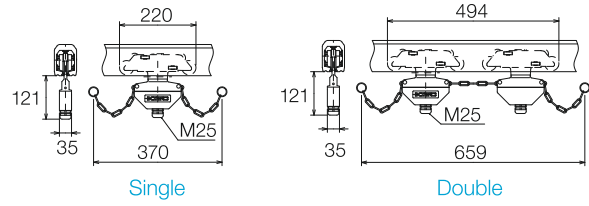

5-2 Cleaning Trolley

- Used for cleaning the conductor within the Busbar.



5-2	Model	Poles	Mass (kg)
	ME4514	4P	0.4

6 Sliding Hanger



- Used for fixing the Busbar.

7 Fixed Hanger



	Model	Type	Mass (kg)
6	ME1510	common	0.1
	ME1500		

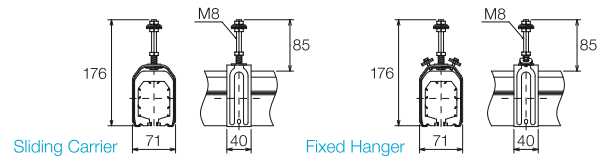

8 Carrier

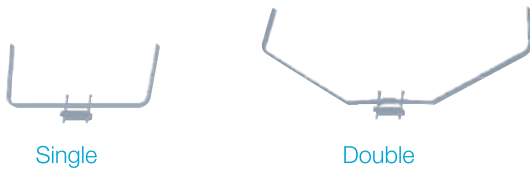

- Used for coupling the trolley and a mobile object (crane or/and hoist).

	Model	Type	Mass (kg)
8	ME1600	Single	0.6
	ME1610	Double	1.1

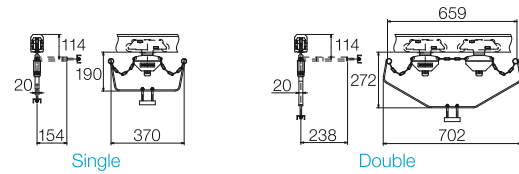

9 Fixing Bracket



- Used for fixing the hanger onto shaped steel, and so on.

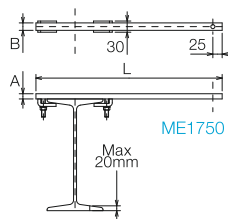

	Model	Length (L) (m)	AxB (mm)	Mass (kg)
9	ME1700	380	15x20	0.5
	ME1750	500		0.6
	ME1760	600	30x30	1.0
	ME1780	850		1.2

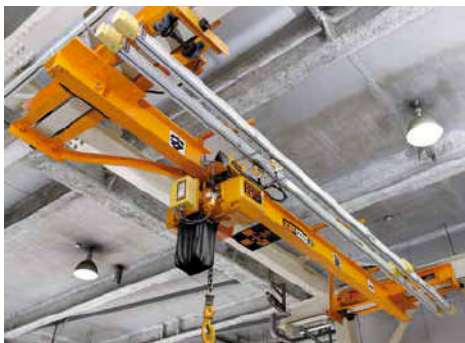

Point of Selection

When selecting the KITO Busbar, take account of the maximum line installation length, voltage drop, and trolley replacement and inspection methods.

1 Max. Line Installation Length (Lmax)

Lmax = 150 m or less

2 Calculation of Voltage Drop

Voltage drop will be as a rule 2% or less of the standard voltage in the trunk line and the branch circuit, respectively.

$$\Delta U = \sqrt{3} \times Z \times L_t \times I$$

I : current in continuous operation or at start-up, as appropriate (in Amperes)

L_t : length of the section considered (in m) (see figure-1)

Z : line impedance (in Ω/m) (see table-1)

ΔU: voltage drop (in volts)

[Figure-1] Calculation

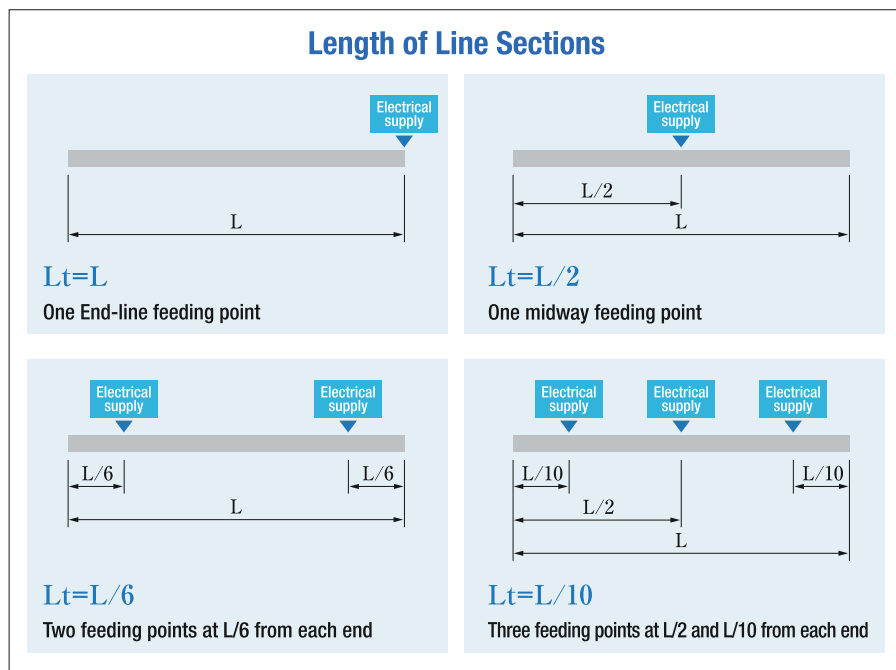

[TABLE-1]

Current rating (A)	Impedance (Ω/m) x 10 ⁻³	
	Ambient temperature 20°C	Ambient temperature 35°C
60	1.2	1.26
100	0.77	0.81



KITO



Head Office & Factory

2000 Tsuijijarai Showa-Cho, Nakakoma-Gun, Yamanashi 409-3853, Japan
TEL: +81-55-275-7521 FAX: +81-55-275-6162

Tokyo Head Office

SHINJUKU NS Bldg. 9F, 2-4-1 Nishi-Shinjuku, Shinjuku-ku, Tokyo 163-0809, Japan
TEL: +81-3-5908-0180 FAX: +81-3-5908-0189
www.kito.co.jp/en KITO Global Website: kito.com

INDIA

KITO INDIA PRIVATE LIMITED

Sy No 118/2 of Jakkur Village, 80 Feet Road,
Jakkur Post, Yelahanka Hobli, Bengaluru – 560064, Karnataka, India
TEL: +91 80 29503090
<https://www.kito.co.in/>

- The functions and performance of the products mentioned in the catalog have been designed based on the related regulations and standards. If they are used for other than their intended purposes such as being integrated into your equipment, we will not take any responsibility for accidents attributable to their unintended usages as well as guarantee their performance and functions. Never remodel our products.
- When you want to use our products for special purposes, consult us in advance.
- When you want to export our products, consult us in advance. There are different standards and regulations from one destination to another.
- It is prohibited to reprint, copy or divert all the information in this catalog (product patents, trademarks, photos, designs, copies, illustrations, etc.) without our consent.
- The specifications in this catalog are partly subject to change without prior notice.
- Product specifications may vary depending on the country. For more details please contact the nearest KITO dealer.